

CARBON CONFIDENCE

EC90 SL DISC | EC90 AERO55 DISC



READY FOR WHAT LIES AHEAD

Easton Cycling believes that our EC90 carbon wheels built to Vault hubs are top of their class; they are so durable we are offering the following 2 year, no fault, guarantee to the original retail purchaser with proof of purchase. At the discretion of Easton Cycling we will, within 2 years of your original purchase, repair or replace your carbon wheel regardless of how the damage occurred or what the damage is. This guarantee covers your complete carbon wheel, including the rim, spokes, and hub with bearings to ensure you have a fully functioning, ride-ready wheel. This guarantee applies to Easton EC90 Carbon Wheels equipped with Easton Vault hubs.

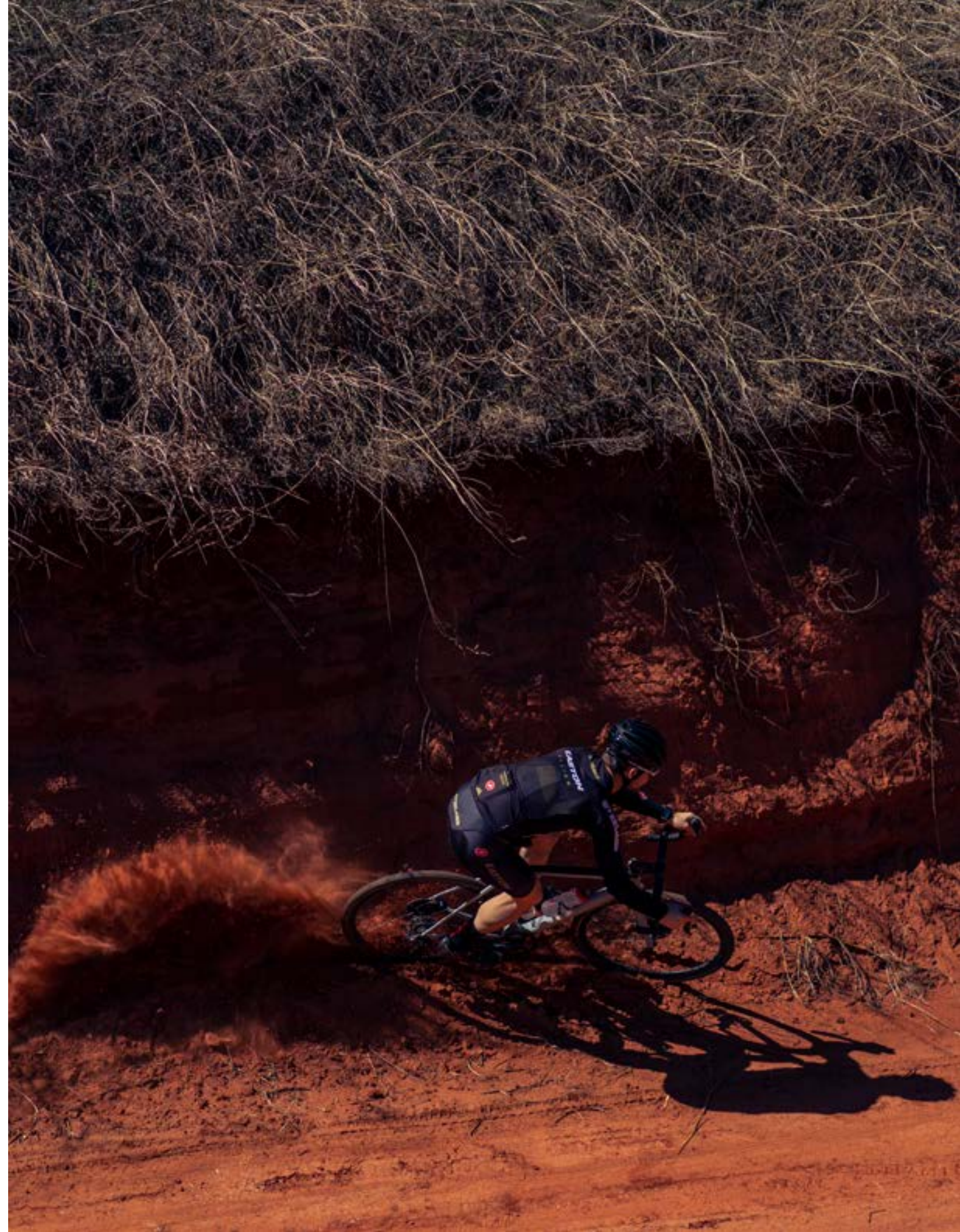

FANTOM RIM PROFILE

We tested the Fantom shape in several different rim depths and found the gains of a rim beyond 55mm to be miniscule—yes we could shave a couple grams of drag, but we'd also add weight and perhaps create a less stable wheel in certain conditions. The Fantom is an exercise in balance—balancing weight, aerodynamics and stability into the best overall package.

Depth of the rim is not the only factor at play in the matter of stability; rim shape also has an impact here. The Fantom possesses a much curved and almost oval profile that blends smoothly with the shape of the tire. As far as the wind is concerned, the rim and tire form an almost continuous profile, which is why the shape proves so aerodynamic.

VAULT HUBS

The new Easton Vault centerlock hub graces all of our new EC90 Disc wheels. With disc road, cyclocross and gravel in mind, the Vault hub was designed from the ground up to exceed your needs from tarmac to sand traps. Larger bearings on a wider bearing stance and improved seals help to push durability to a new level.

A reversed drive ring configuration, used on the Echo road hub with a less than 0.1% warranty return rate, gives 60 points of engagement at just 6-degrees for instant acceleration. Included in the box are tool-free swappable end-caps for all major axle standards

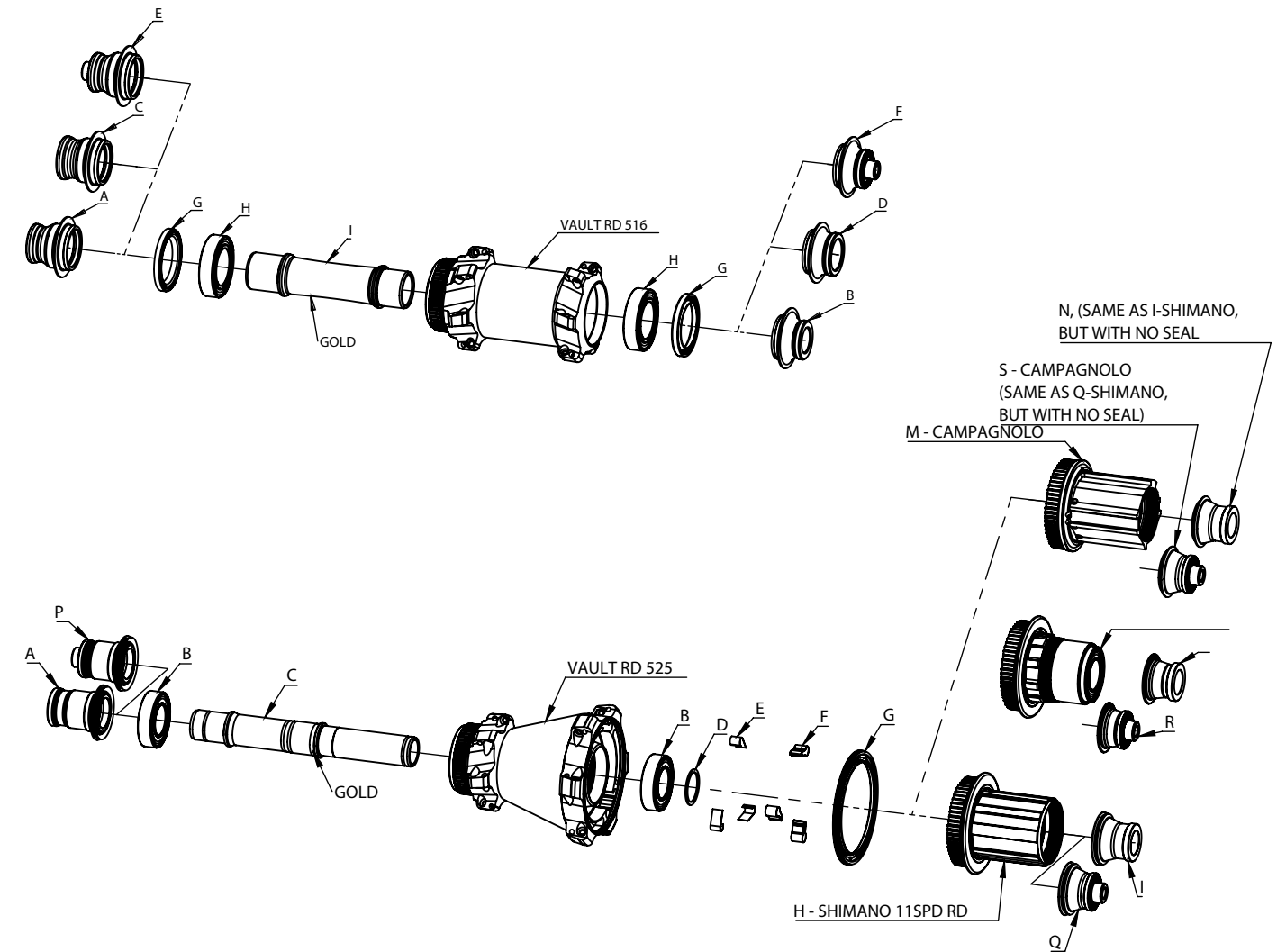



EC90 SL

DISC WHEELSET

WHATEVER YOU RIDE FOR

A privateer's favorite wheelset, our EC90 SL easily transitions from winding alpine ascents to shredding the back 40. Put through its paces by elite road and cyclocross riders alike, the EC90 SL is built to endure, giving you the speed and confidence to stay ahead of the pack.

Our improved tubeless ready EC90 SL Disc Phantom rims are laced to our new purpose-built Vault hub. Thanks to larger bearings on a wider bearing stance and improved seals, your hub will have a longer lifespan and require less maintenance. The oversized hub-shell offers increased rear drive torsional and lateral stiffness for a more direct power transfer. The reversed drive ring configuration has just 6 degrees of engagement, making it twice as quick as the industry standard.

With the EC Carbon Confidence 2-year no-questions-asked guarantee, tool-free swappable end-caps for all major axle standards, as well as five extra straight-pull Sapim spokes (included with our rear wheels), your EC90 SL wheelset is ready for whatever you can throw at it.

WHEEL WEIGHT	1485g
FINISH	MATTE CARBON / HIGH GLOSS LOGOS
TYPE	TUBELESS READY CARBON CLINCHER
RIM MATERIAL	EC90 CARBON
RIM DEPTH	38mm
INTERNAL RIM WIDTH	19mm
EXTERNAL RIM WIDTH	28mm
SPOKES	SAPIM STRAIGHT-PULL / CX-RAY
SPOKE PATTERN	24 / 3X
ROTOR MOUNT	CENTER LOCK
NIPPLE TYPE	DT EXTERNAL ALLOY
FRONT/REAR HUB	EASTON VAULT CENTER LOCK - 12X100* / 12X142*
FREEHUB OPTIONS	SHIMANO, XDR OR CAMPAGNOLO
ENGAGEMENT	60 POINT, 6°
BEARING TYPE	SEALED CARTRIDGE BEARINGS

*STOCK CONFIGURATION: CONVERTABLE TO ALL MAJOR AXLE STANDARDS

EC90 AERO55 DISC WHEELSET

DISC EQUIPPED, CRIT READY

The EC90 Aero55s bring the aero to your everyday, helping you focus your preparation without losing a beat. No longer will you need to swap wheels out between training rides and races - this wheelset does it all.

Featuring our proven aero Phantom rims laced to the new Vault hubs, this lightweight wheelset offers excellence to riders wanting to test their mettle on the start line with the wheels they've been training on all season. You'll still be able to run your favorite tires without losing aero advantage on the tubeless-ready rims with widths optimized for stability in crosswinds. And now with the Vault hub's durable bearing design, and fast engagement, you can be ready to excel year round.

With the EC Carbon Confidence 2-year no-questions-asked guarantee, tool-free swappable end-caps for all major axle standards, as well as five extra straight-pull Sapim spokes (included with our rear wheels), your EC90 Aero55 wheels will ride true for years to come.

WHEEL WEIGHT	1545g
FINISH	MATTE CARBON / HIGH GLOSS LOGOS
TYPE	TUBELESS READY CARBON CLINCHER
RIM MATERIAL	EC90 CARBON
RIM DEPTH	55MM
INTERNAL RIM WIDTH	19MM
EXTERNAL RIM WIDTH	28MM
SPOKES	SAPIM STRAIGHT-PULL / CX-RAY
SPOKE PATTERN	24 / 3X
ROTOR MOUNT	CENTER LOCK
NIPPLE TYPE	DT EXTERNAL ALLOY
FRONT/REAR HUB	EASTON VAULT CENTER LOCK - 12X100* / 12X142*
FREEHUB OPTIONS	SHIMANO, XDR OR CAMPAGNOLO
ENGAGEMENT	60 POINT, 6°
BEARING TYPE	SEALED CARTRIDGE BEARINGS

*STOCK CONFIGURATION: CONVERTABLE TO ALL MAJOR AXLE STANDARDS



